

REV	ECN NO.	DESCRIPTION	DRN	APP'D	DATE

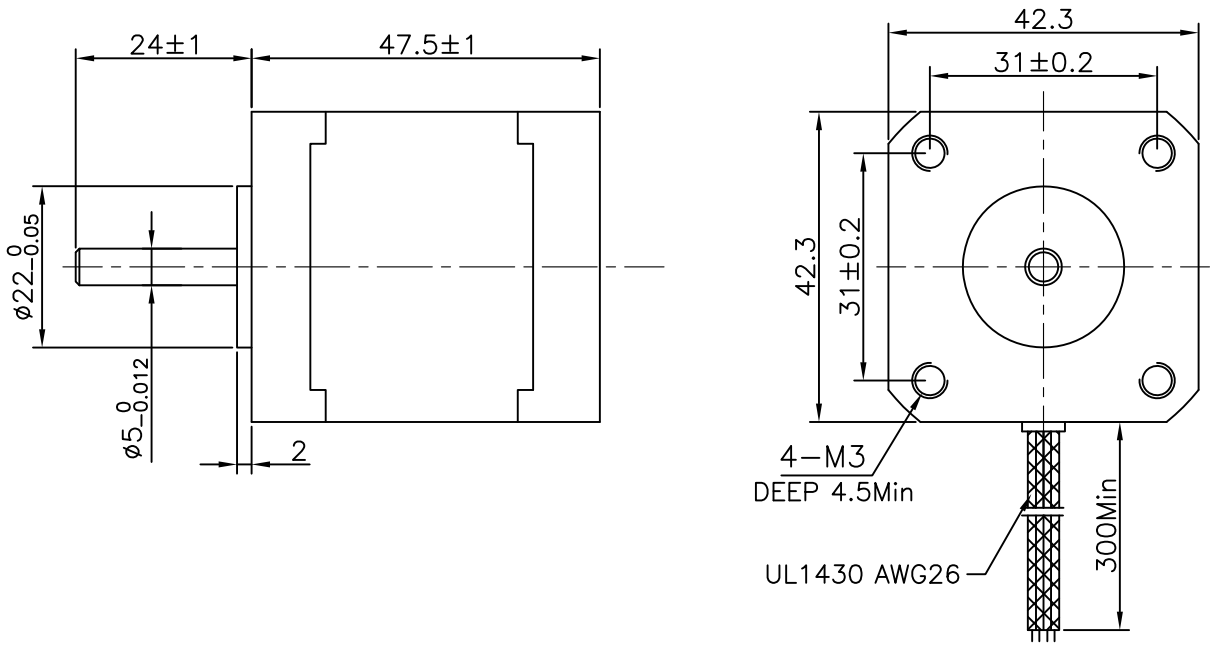

Wiring Diagram (接线图)

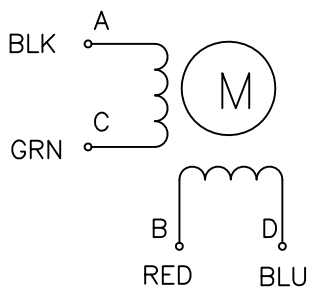

Exciting Sequence (励磁顺序)

CW DIRECTION	STEP	A	C	B	D
↓	1	+		+	
	2		+	+	
	3		+		+
	4	+			+
	1	+		+	

CW, see from flange side  
(顺时针, 从法兰侧看)

SPECIFICATION

STEP ANGLE	步距角	1.8°/full step (整步)
STEP ANGLE ACCURACY	步距角精度	±5%
NUMBER OF PHASE	绕组相数	2
RATED VOLTAGE	额定电压	5.54 VDC
RATED CURRENT	额定电流	0.95 A
RESISTANCE/PHASE	每相电阻	5.83±10% ohms@20°C
INDUCTANCE/PHASE	每相电感	10.02±20% mH@1kHz
HOLDING TORQUE	保持转矩	5000 g.cm
PULL OUT TORQUE	运行转矩	N.cm@ RPM
BACK EMF	反电动势	V @300RPM
DETENT TORQUE	定位转矩	N.cm
ROTOR INERTIA	转子转动惯量	68 g.cm <sup>2</sup>
WEIGHT	重量	350 g
TEMPERATURE RISE	温升	Less than 80K (小于80开)
SOURCE VOLTAGE	驱动器电压	24 VDC
INSULATION CLASS	绝缘等级	B 130°C
DIELECTRIC STRENGTH	介电强度	500VAC 1MIN
INSULATION RESISTANCE	绝缘电阻	100MΩ @ 500VDC
IP CODE	防护等级	IP30
OPERATION AMBIENT	使用环境	Ambient temperature: -25...+40°C, humidity Max. 85%(No condensation)
STORAGE AMBIENT	存储环境	Ambient temperature: -10...+35°C, humidity Max. 85%(No condensation)

PERMISSIBLE RADIAL+AXIAL FORCE  
(允许的轴向和径向力)

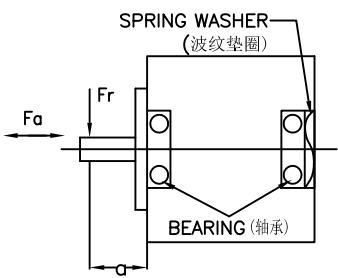

AXIAL-FORCE 轴向压力	Fa=10 N Max.
DISTANCE 距离	a=20 mm
RADIAL-FORCE 径向压力	Fr=28 N Max.
SHAFT RADIAL PLAY 径向间隙	0.02mm Max. @4N
SHAFT AXIAL PLAY 轴向间隙	0.08mm Max. @4N

DESIGN	DATE	P/N.	3.1.01.042.NEW
UNLESS OTHERWISE SPECIFIED TOLERANCES:	15-05-13	TITLE	Specifications
DECIMALS: .x ±0.5	MATERIAL	USED ON	JD42STH47-0954A
ANGULAR: .xx ±0.25	CONTR.	DWG NO.	REV
.xxx ±0.1	CHECK	APPD	
UNIT: mm	FIRST ANGLE PROJECTION	SCALE	NTS
DO NOT SCALE DRAWING		SHEET	OF
		JDS MOTION	